



APPRENTICE OF THE YEAR	
RESOURCE	NATIONAL PRACTICAL PROJECT
COMPETITION YEAR	2024
PROJECT	GARDEN HOUSE

APPRENTICE OF THE YEAR

RESOURCE	NATIONAL PRACTICAL PROJECT
COMPETITION YEAR	2024
PROJECT	GARDEN HOUSE



Apprentice Practical Tool List – National

Please read the tools list carefully as you need to make sure you bring all of these with you to the practical challenge.

Only bring what is on the list, nothing else will be allowed.

	Use this box to tick you have each tool.
HOLES SAW & BITS	
Drill bits, (Twist) up to 13mm (for using in metal and wood)	
Countersunk bit	
A set of screw driver bits (square drive #1 & 2) needs to fit battery impact driver	
APRON WITH THE FOLLOWING	
Apron	
Knife (to sharpen pencil)	
Pencil	
Hammer	
20mm Chisel	
Nail punch	
Rule	
square that does 90° and 45	
Tape measure	
Calculator or you can use your phone	
HAND TOOLS	
15mm and 25mm Chisel	
Block Plane – if you do not have one you can borrow one	
Wire Nips (the type used for tying steel)	
Doggy Bar	
Timber Rasp both fine and course	
2 off Quick Grip Clamps or "F" Clamps (if possible, a jaw of 200mm)	
Hand Saw	
Sanding block	
Drawing Compass OR dividers	
HEALTH & SAFETY GEAR	
Earmuffs	
Safety glasses	
Any medication needed	
Safety shoes	
Safety Gloves	
Optional knee pads	
Dustpan and brush	

APPRENTICE OF THE YEAR

RESOURCE	NATIONAL PRACTICAL PROJECT
COMPETITION YEAR	2024
PROJECT	GARDEN HOUSE

Apprentice Instructions – AOY Nationals 2024**GARDEN HOUSE**

- Assume the floor structure is level
- Check material sizes as may vary from plan and instruction dimensions
- Overall width of framing, 1400mm, centred on subfloor base framing
- Top plate mitred to end studs with bottom plate cut between end studs
- Equally spaced studs
- Decking equally spaced, screw fixed, set back at front for ripping and rear vertical decking boards
- Back rail notched around studs and aligned with top of T&G boards, once tongue removed from top of T&G boards, bevel to remain
- Rear rail rebated 25mm for vertical boards
- External corners of T&G boards mitred, screwed using bugal screws. Rear T&G boards against studs (screwed using 100mm x 10g screws) are fitted between front and rear T&G boards
- T&G board corners strengthened using 45x45, set 30mm down from top
- Lower T&G boards supported along length using wedge blocks, from 200x50 offcuts, upper 2 boards supported using 90x45, centred on T&G board joint
- Rafters equally spaced, 87mm overhang to tail plumb cut from plate/wall
- Rear rafters mitred at apex, ridge butted into rafters
- Barge board tail shaped to form half circle, with bottom edge of circle aligning with outer edge of stud
- Plywood roof screwed to structure (50mmx8g screws) equally spaced to perimeter, no more than 150mm centres and 300mm to intermediate rafters, screws centred on members Ply overhangs back rafters by 15mm
- Planter box base boards cut within T&G boards, 5mm gap between boards
- Front deck capping to have rounded ends
- Barge board positioned 15mm above roof plywood

APPRENTICE OF THE YEAR

RESOURCE	NATIONAL PRACTICAL PROJECT
COMPETITION YEAR	2024
PROJECT	GARDEN HOUSE

CARTERS
Your Building Partner

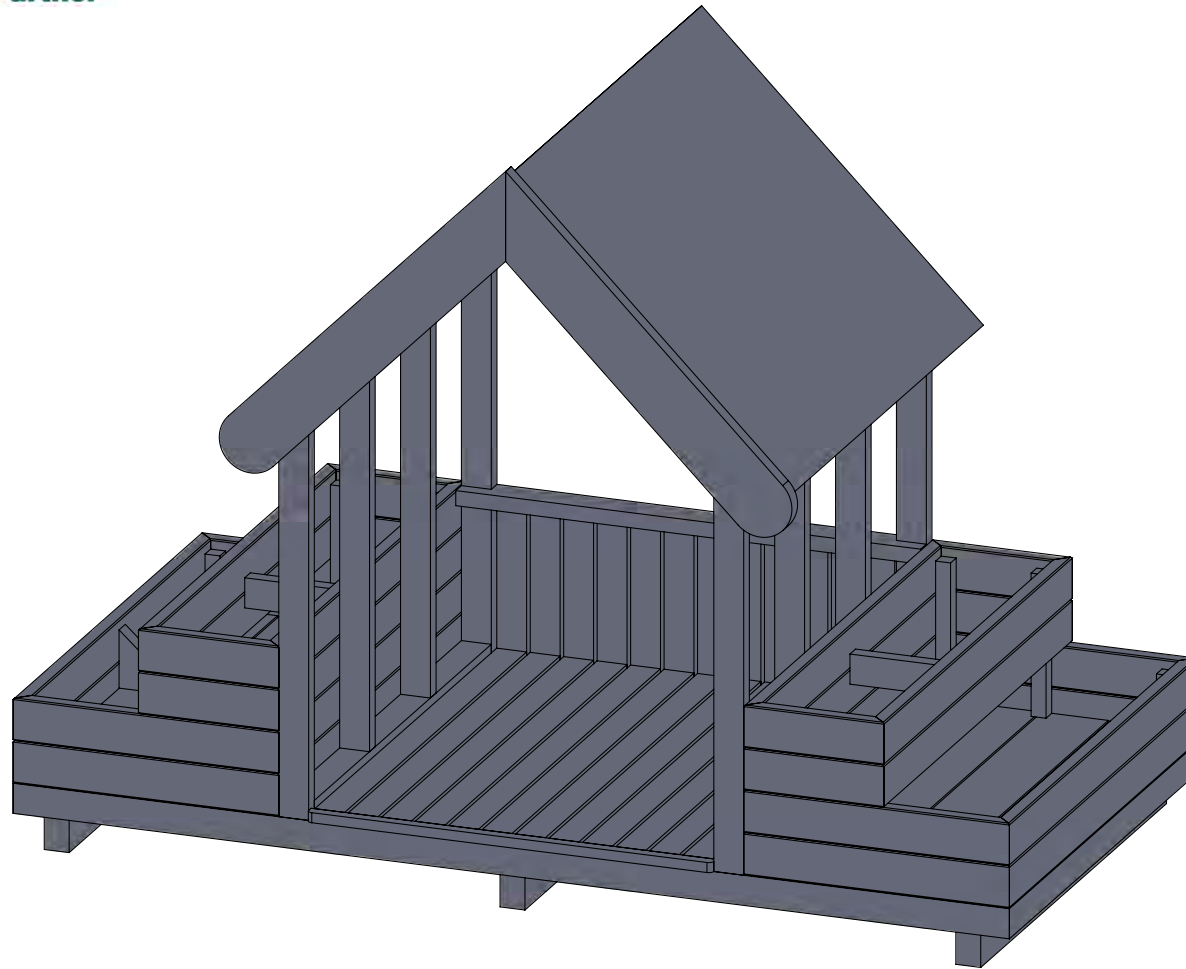

Garden House

APPRENTICE OF THE YEAR 2024 - Finals

APPRENTICE OF THE YEAR

RESOURCE	NATIONAL PRACTICAL PROJECT
COMPETITION YEAR	2024
PROJECT	

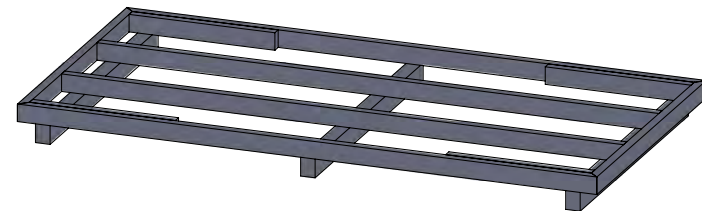
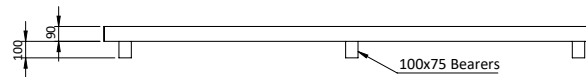
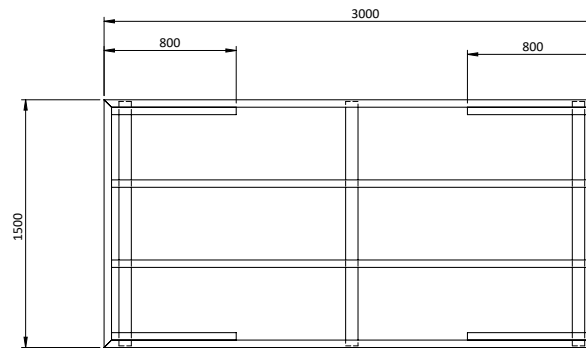

Garden House - Subfloor

APPRENTICE OF THE YEAR 2024 - Finals

APPRENTICE OF THE YEAR

RESOURCE NATIONAL PRACTICAL PROJECT

COMPETITION YEAR 2024

PROJECT GARDEN HOUSE

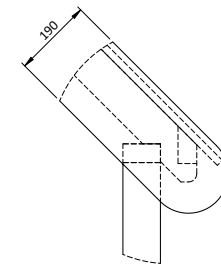
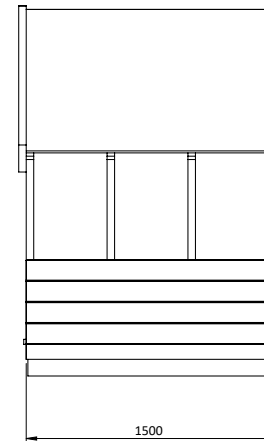
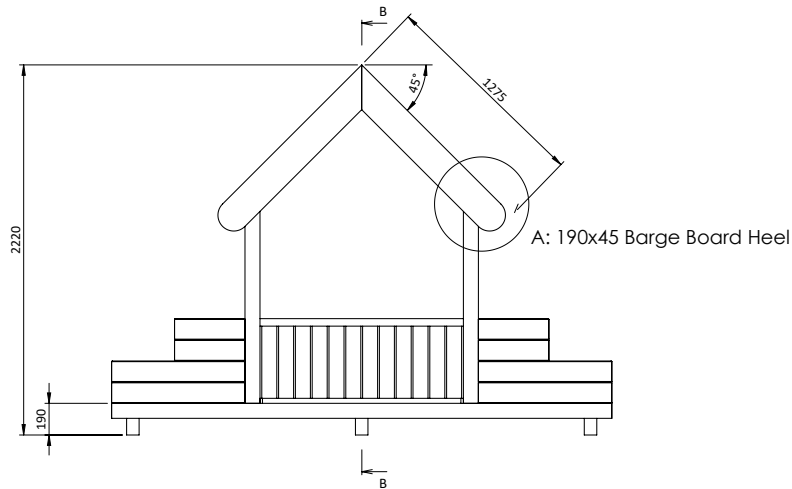
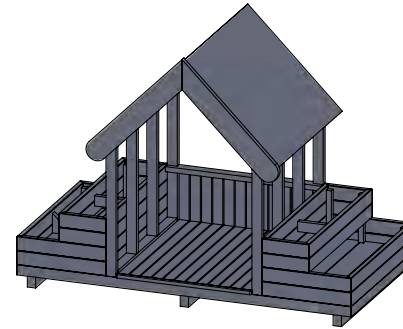
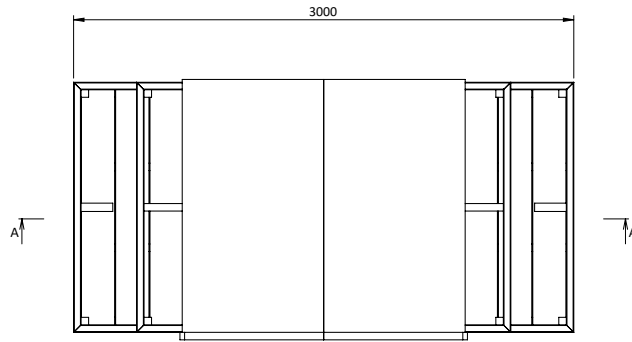

A: 190x45 Barge Board Heel

Garden House - Main
APPRENTICE OF THE YEAR 2024 - Finals

APPRENTICE OF THE YEAR

RESOURCE NATIONAL PRACTICAL PROJECT

COMPETITION YEAR 2024

PROJECT GARDEN HOUSE

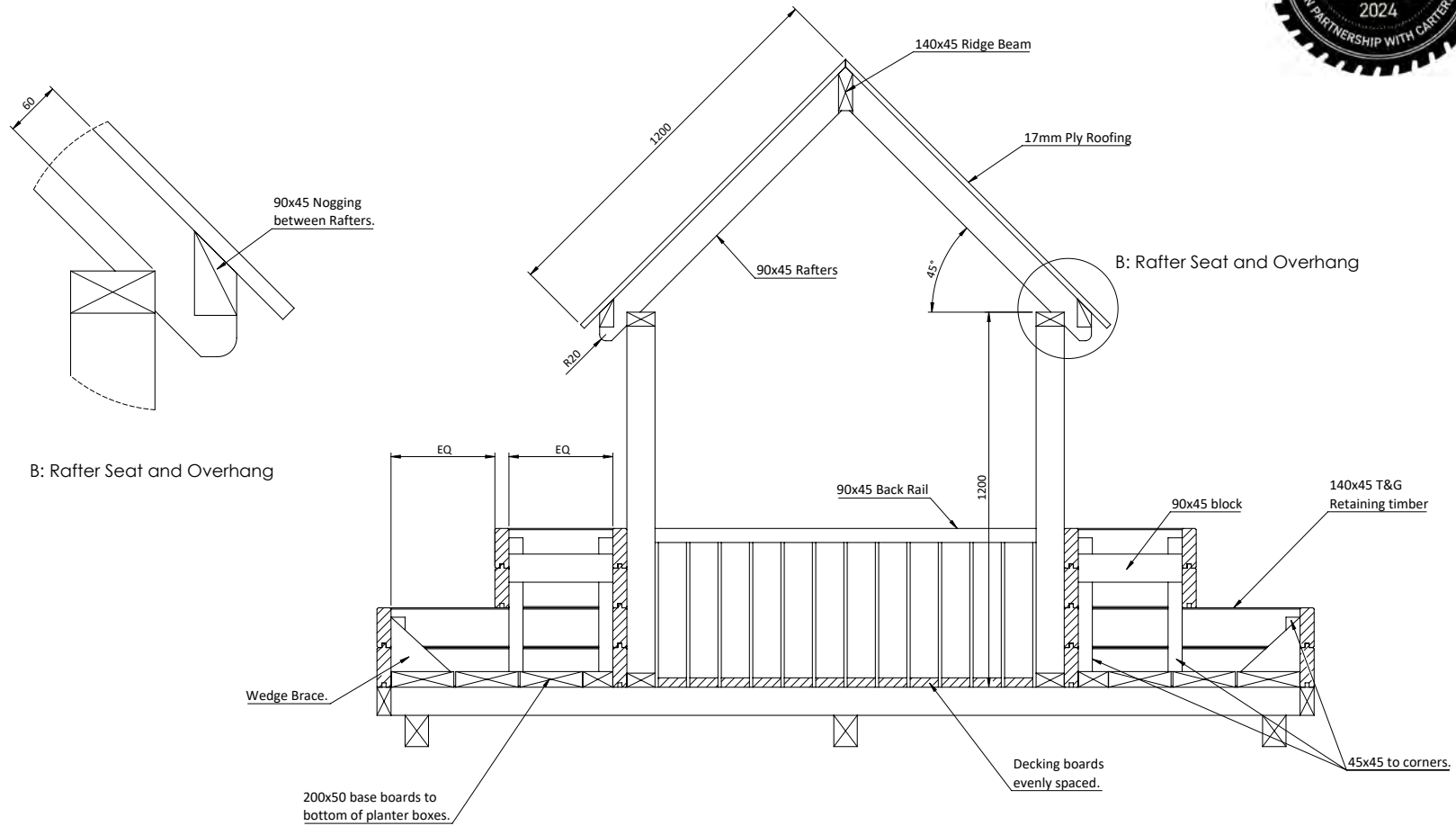

Garden House - Section AA
APPRENTICE OF THE YEAR 2024 - Finals

APPRENTICE OF THE YEAR

RESOURCE	NATIONAL PRACTICAL PROJECT
COMPETITION YEAR	2024
PROJECT	GARDEN HOUSE

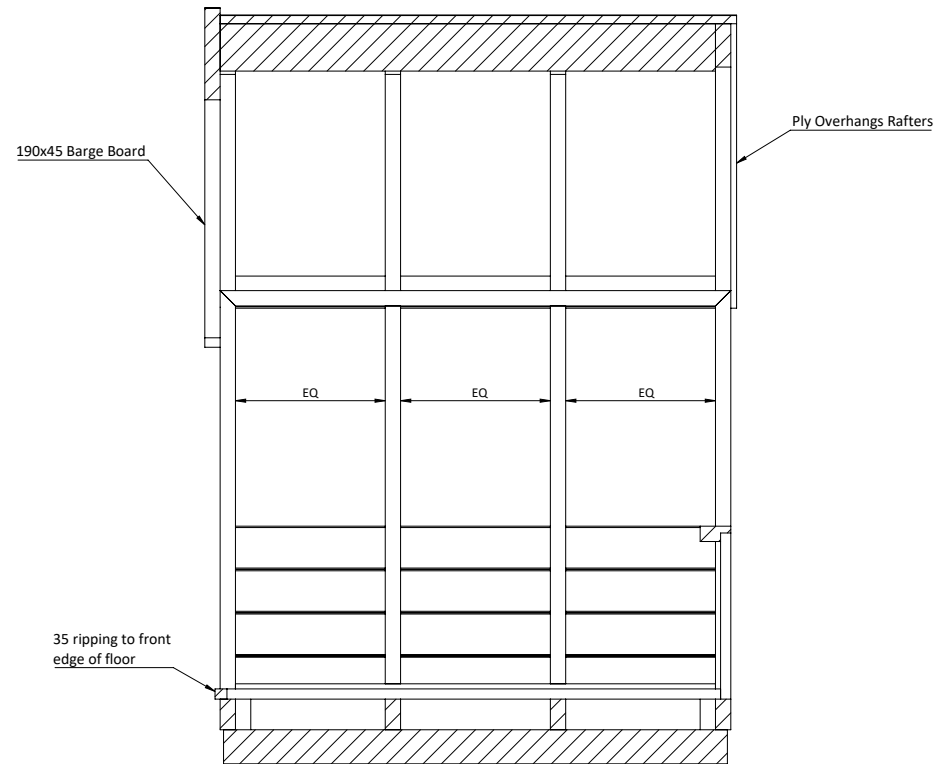

Garden House - Section BB

APPRENTICE OF THE YEAR 2024 - Finals